

# PERMCO

# DUMP PUMPS

## **PUMP/VALVE ASSEMBLY FOR HEAVY AND MEDIUM DUTY DUMP TRUCKS AND TRAILERS**

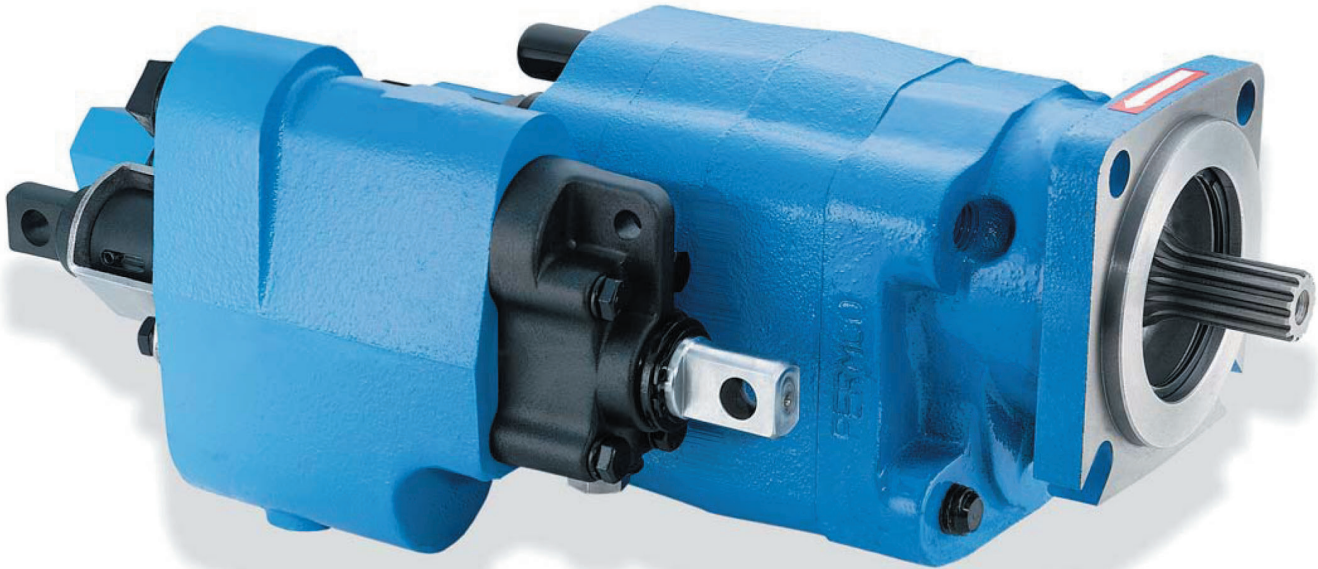

### **DUMP PUMP FEATURES**

- Pump and cylinder protected in the “Raise” and “Neutral” position of the spool
- Manual shift, factory installed “OE” air, or “Add-on” air shifts each with full metering capabilities
- Built-in load check maintains dump body angle and is installed in the cylinder port for superior self-cleaning
- Direct mount SAE “B” 4 bolt or twin shafted remote mount with bracket
- Built-in direct acting relief valve set at factory
- 100% factory tested
- Flows of 37 and 46 GPM at 1800 RPM
- Pressures to 2500 PSI
- Speeds to 2400 RPM
- High strength alloy steel gear and shaft set
- Neutral lock-out safety cap for use with pull-out cable
- 2 line for intermittent duty or 3 line for continuous duty systems
- 2 extra long studs for easy installation of pump support bracket on direct mount
- Pressure balanced wear plates maintain high pump efficiency throughout all operating ranges

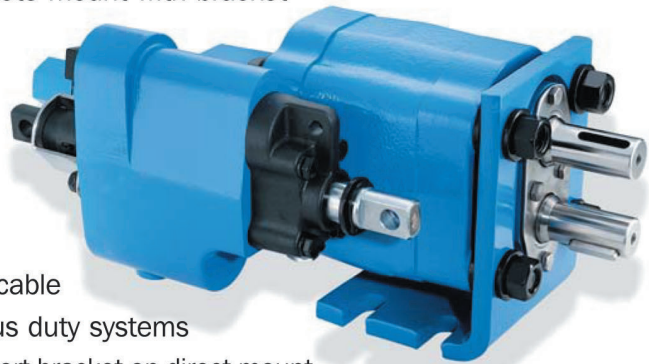

## *The Sensible Choice*

**Holtz Industries, Inc. | 200 S. Terrace Ct. | Newark, OH 43055  
Toll Free: 1-800-535-0104 | Fax: 740-366-0771**

# Dimensional Data (inches)

Dump Pumps are not recommended for ejector, conveyor, or moving floor type applications; please refer to Genesis brochure (bult # 02-406G) for those type or applications

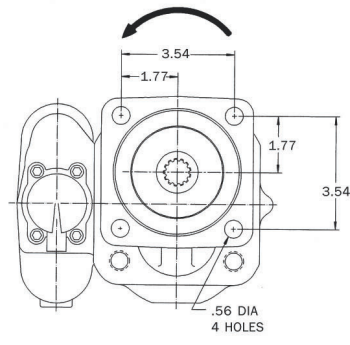
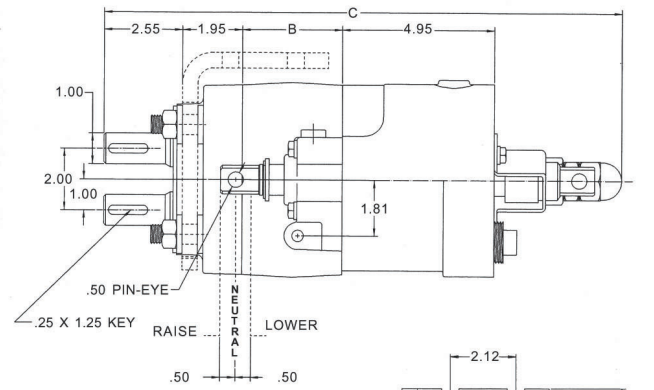
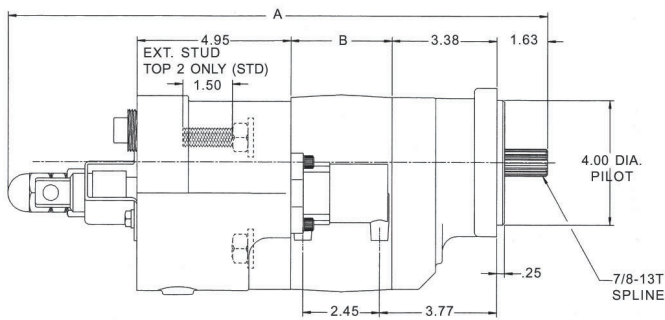

UNIT SHOWN C.C.W.

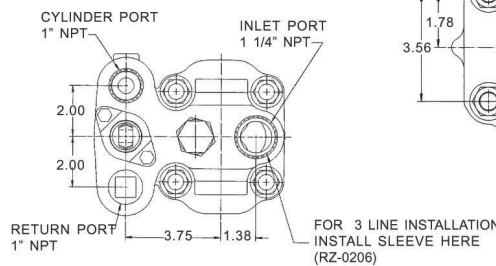

PORT VIEW SHOWN FOR BOTH DIRECT AND REMOTE MOUNT

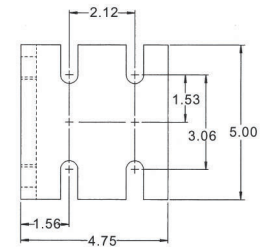
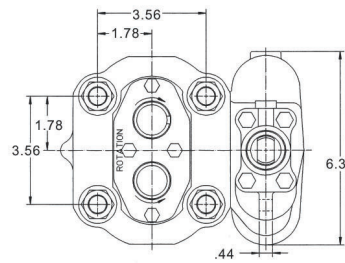

	A	B
DMD-20	16.85"	2.75"
DMD-25	17.35"	3.25"

	C	B
DM-512-20	16.35"	2.75"
DM-640-25	16.85"	3.25"

## Pump Code

### DMD - 25 - Z - L - AS - 20 - EB

Direct Mount, SAE 4 Bolt "B"

- 20** 2.0" Gear / 37 GPM at 1800 RPM
- 25** 2.5" Gear / 46 GPM at 1800 RPM

- X** 2 Line (Without 3 Line Sleeve)
- Z** 3 Line (With 3 Line Sleeve)

- L** Left Hand Rotation
- R** Right Hand Rotation

#### Extended Stud Orientation

- Delete** Top Two (Std.)
- EB** Bottom Two
- EL** Left Side
- ER** Right Side
- E4** All four

#### Relief Valve Setting

- 20** 2000 PSI
- 25** 2500 PSI

- AS** Air Shift
- MS** Manual Shift

### DM - 640 - 25 - ZR - M - T - 200

Remote Mount

- 512-20** In.<sup>3</sup> x 100 / 2.0" Gear / 37 GPM at 1800 RPM
- 640-25** In.<sup>3</sup> x 100 / 2.5" Gear / 46 GPM at 1800 RPM

- X** 2 Line (Without 3 Line Sleeve)
- Z** 3 Line (With 3 Line Sleeve)

#### Valve Orientation

- L** Left Side
- R** Right Side (Std.)

#### Relief Valve Setting

- 200** 2000 PSI
- 250** 2500 PSI

- T** Manual Shift
- AS** "OE" Air Shift
- M** With Mounting Bracket (Std.)
- O** Without Mounting Bracket

Holtz Industries, Inc. | 200 S. Terrace Ct. | Newark, OH 43055

Toll Free; 1-800-535-0104 | Fax: 740-366-0771